

# Short Environmental Assessment Form

## Part 1 - Project Information

### Instructions for Completing

**Part 1 - Project Information.** The applicant or project sponsor is responsible for the completion of Part 1. Responses become part of the application for approval or funding, are subject to public review, and may be subject to further verification. Complete Part 1 based on information currently available. If additional research or investigation would be needed to fully respond to any item, please answer as thoroughly as possible based on current information.

Complete all items in Part 1. You may also provide any additional information which you believe will be needed by or useful to the lead agency; attach additional pages as necessary to supplement any item.

<b>Part 1 - Project and Sponsor Information</b>				
Subdivision of lot at 1010 Triphammer Road				
Name of Action or Project:				
Project Location (describe, and attach a location map): 1010 Triphammer Road to be divided into two similar size lots (see map)				
Brief Description of Proposed Action: I have had my property at 1010 Triphammer Road surveyed by T.G.Miller to reflect a subdivision into two lots, one vacant, the other, containing my house, which would remain 1010 Triphammer Road.  At some point, I might like to build a small house on the vacant lot, or I might want to sell the land to someone else.				
Name of Applicant or Sponsor: Wendy Kimble-Dugan		Telephone: (607) 257-5528		
		E-Mail: wendykaydee@gmail.com		
Address: 1010 Triphammer Road				
City/PO: Ithaca		State: New York	Zip Code: 14850	
1. Does the proposed action only involve the legislative adoption of a plan, local law, ordinance, administrative rule, or regulation? If Yes, attach a narrative description of the intent of the proposed action and the environmental resources that may be affected in the municipality and proceed to Part 2. If no, continue to question 2.			<b>NO</b>	<b>YES</b>
			<input checked="" type="checkbox"/>	<input type="checkbox"/>
2. Does the proposed action require a permit, approval or funding from any other governmental Agency? If Yes, list agency(s) name and permit or approval:			<b>NO</b>	<b>YES</b>
			<input checked="" type="checkbox"/>	<input type="checkbox"/>
3.a. Total acreage of the site of the proposed action?		_____ 0.535 acres		
b. Total acreage to be physically disturbed?		_____ 0.535 acres		
c. Total acreage (project site and any contiguous properties) owned or controlled by the applicant or project sponsor?		_____ 0.535 acres		
4. Check all land uses that occur on, adjoining and near the proposed action.				
<input type="checkbox"/> Urban <input type="checkbox"/> Rural (non-agriculture) <input type="checkbox"/> Industrial <input type="checkbox"/> Commercial <input checked="" type="checkbox"/> Residential (suburban)				
<input type="checkbox"/> Forest <input type="checkbox"/> Agriculture <input type="checkbox"/> Aquatic <input type="checkbox"/> Other (specify): _____				
<input type="checkbox"/> Parkland				

5. Is the proposed action, a. A permitted use under the zoning regulations?	<b>NO</b>	<b>YES</b>	<b>N/A</b>
	<input type="checkbox"/>	<input checked="" type="checkbox"/>	<input type="checkbox"/>
b. Consistent with the adopted comprehensive plan?	<input type="checkbox"/>	<input checked="" type="checkbox"/>	<input type="checkbox"/>
6. Is the proposed action consistent with the predominant character of the existing built or natural landscape?	<b>NO</b>	<b>YES</b>	
	<input type="checkbox"/>	<input checked="" type="checkbox"/>	
7. Is the site of the proposed action located in, or does it adjoin, a state listed Critical Environmental Area? If Yes, identify: _____ _____	<b>NO</b>	<b>YES</b>	
	<input checked="" type="checkbox"/>	<input type="checkbox"/>	
8. a. Will the proposed action result in a substantial increase in traffic above present levels?	<b>NO</b>	<b>YES</b>	
	<input checked="" type="checkbox"/>	<input type="checkbox"/>	
b. Are public transportation service(s) available at or near the site of the proposed action?	<input type="checkbox"/>	<input checked="" type="checkbox"/>	
c. Are any pedestrian accommodations or bicycle routes available on or near site of the proposed action?	<input type="checkbox"/>	<input checked="" type="checkbox"/>	
9. Does the proposed action meet or exceed the state energy code requirements? If the proposed action will exceed requirements, describe design features and technologies: _____ _____	<b>NO</b>	<b>YES</b>	
	<input type="checkbox"/>	<input checked="" type="checkbox"/>	
10. Will the proposed action connect to an existing public/private water supply?  If No, describe method for providing potable water: _____ _____	<b>NO</b>	<b>YES</b>	
	<input type="checkbox"/>	<input checked="" type="checkbox"/>	
11. Will the proposed action connect to existing wastewater utilities?  If No, describe method for providing wastewater treatment: _____ _____	<b>NO</b>	<b>YES</b>	
	<input type="checkbox"/>	<input checked="" type="checkbox"/>	
12. a. Does the site contain a structure that is listed on either the State or National Register of Historic Places?	<b>NO</b>	<b>YES</b>	
	<input checked="" type="checkbox"/>	<input type="checkbox"/>	
b. Is the proposed action located in an archeological sensitive area?	<input checked="" type="checkbox"/>	<input type="checkbox"/>	
13. a. Does any portion of the site of the proposed action, or lands adjoining the proposed action, contain wetlands or other waterbodies regulated by a federal, state or local agency?	<b>NO</b>	<b>YES</b>	
	<input checked="" type="checkbox"/>	<input type="checkbox"/>	
b. Would the proposed action physically alter, or encroach into, any existing wetland or waterbody? If Yes, identify the wetland or waterbody and extent of alterations in square feet or acres: _____ <i>EAF Mapper responds "yes" to Question 13a. There is a small wetland area along the northern parcel boundary. However, this wetland area, which is associated with a small intermittent stream and culvert under Triphammer Road, is not mapped or regulated by any federal, state, or local agency.</i>	<input checked="" type="checkbox"/>	<input type="checkbox"/>	
14. Identify the typical habitat types that occur on, or are likely to be found on the project site. Check all that apply: <input type="checkbox"/> Shoreline <input type="checkbox"/> Forest <input type="checkbox"/> Agricultural/grasslands <input type="checkbox"/> Early mid-successional <input type="checkbox"/> Wetland <input type="checkbox"/> Urban <input checked="" type="checkbox"/> Suburban			
15. Does the site of the proposed action contain any species of animal, or associated habitats, listed by the State or Federal government as threatened or endangered?	<b>NO</b>	<b>YES</b>	
	<input checked="" type="checkbox"/>	<input type="checkbox"/>	
16. Is the project site located in the 100 year flood plain?	<b>NO</b>	<b>YES</b>	
	<input checked="" type="checkbox"/>	<input type="checkbox"/>	
17. Will the proposed action create storm water discharge, either from point or non-point sources? If Yes, a. Will storm water discharges flow to adjacent properties? <input type="checkbox"/> NO <input type="checkbox"/> YES	<b>NO</b>	<b>YES</b>	
	<input checked="" type="checkbox"/>	<input type="checkbox"/>	
b. Will storm water discharges be directed to established conveyance systems (runoff and storm drains)? If Yes, briefly describe: _____ _____			

<p>18. Does the proposed action include construction or other activities that result in the impoundment of water or other liquids (e.g. retention pond, waste lagoon, dam)?</p> <p>If Yes, explain purpose and size: _____</p> <p>_____</p> <p>_____</p>	<p><b>NO</b></p> <p><input checked="" type="checkbox"/></p>	<p><b>YES</b></p> <p><input type="checkbox"/></p>
<p>19. Has the site of the proposed action or an adjoining property been the location of an active or closed solid waste management facility?</p> <p>If Yes, describe: _____</p> <p>_____</p> <p>_____</p>	<p><b>NO</b></p> <p><input checked="" type="checkbox"/></p>	<p><b>YES</b></p> <p><input type="checkbox"/></p>
<p>20. Has the site of the proposed action or an adjoining property been the subject of remediation (ongoing or completed) for hazardous waste?</p> <p>If Yes, describe: _____</p> <p>_____</p> <p>_____</p>	<p><b>NO</b></p> <p><input checked="" type="checkbox"/></p>	<p><b>YES</b></p> <p><input type="checkbox"/></p>
<p><b>I AFFIRM THAT THE INFORMATION PROVIDED ABOVE IS TRUE AND ACCURATE TO THE BEST OF MY KNOWLEDGE</b></p> <p>Applicant/sponsor name: Wendy Kimble Dugan _____ Date: 5/17/2016 _____</p> <p>Signature: <i>Wendy Kimble Dugan</i> _____</p>		

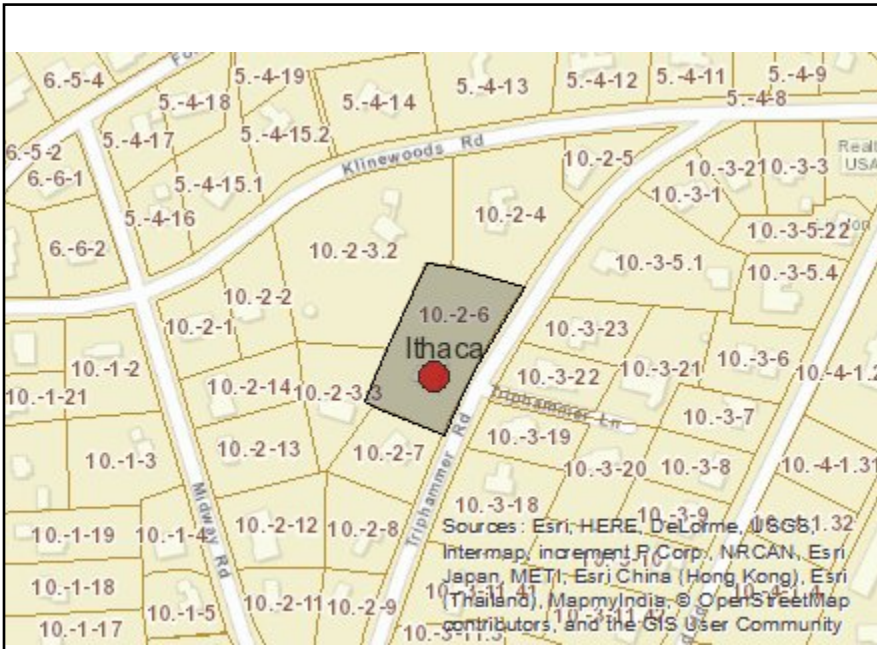

**Disclaimer:** The EAF Mapper is a screening tool intended to assist project sponsors and reviewing agencies in preparing an environmental assessment form (EAF). Not all questions asked in the EAF are answered by the EAF Mapper. Additional information on any EAF question can be obtained by consulting the EAF Workbooks. Although the EAF Mapper provides the most up-to-date digital data available to DEC, you may also need to contact local or other data sources in order to obtain data not provided by the Mapper. Digital data is not a substitute for agency determinations.



Part 1 / Question 7 [Critical Environmental Area]	No
Part 1 / Question 12a [National Register of Historic Places]	No
Part 1 / Question 12b [Archeological Sites]	No
Part 1 / Question 13a [Wetlands or Other Regulated Waterbodies]	Yes - Digital mapping information on local and federal wetlands and waterbodies is known to be incomplete. Refer to EAF Workbook.
Part 1 / Question 15 [Threatened or Endangered Animal]	No
Part 1 / Question 16 [100 Year Flood Plain]	Digital mapping data are not available or are incomplete. Refer to EAF Workbook.
Part 1 / Question 20 [Remediation Site]	No

**Part 2 - Impact Assessment. The Lead Agency is responsible for the completion of Part 2.** Answer all of the following questions in Part 2 using the information contained in Part 1 and other materials submitted by the project sponsor or otherwise available to the reviewer. When answering the questions the reviewer should be guided by the concept “Have my responses been reasonable considering the scale and context of the proposed action?”

	No, or small impact may occur	Moderate to large impact may occur
1. Will the proposed action create a material conflict with an adopted land use plan or zoning regulations?	<input checked="" type="checkbox"/>	<input type="checkbox"/>
2. Will the proposed action result in a change in the use or intensity of use of land?	<input checked="" type="checkbox"/>	<input type="checkbox"/>
3. Will the proposed action impair the character or quality of the existing community?	<input checked="" type="checkbox"/>	<input type="checkbox"/>
4. Will the proposed action have an impact on the environmental characteristics that caused the establishment of a Critical Environmental Area (CEA)?	<input checked="" type="checkbox"/>	<input type="checkbox"/>
5. Will the proposed action result in an adverse change in the existing level of traffic or affect existing infrastructure for mass transit, biking or walkway?	<input checked="" type="checkbox"/>	<input type="checkbox"/>
6. Will the proposed action cause an increase in the use of energy and it fails to incorporate reasonably available energy conservation or renewable energy opportunities?	<input checked="" type="checkbox"/>	<input type="checkbox"/>
7. Will the proposed action impact existing:	<input checked="" type="checkbox"/>	<input type="checkbox"/>
a. public / private water supplies?	<input checked="" type="checkbox"/>	<input type="checkbox"/>
b. public / private wastewater treatment utilities?	<input checked="" type="checkbox"/>	<input type="checkbox"/>
8. Will the proposed action impair the character or quality of important historic, archaeological, architectural or aesthetic resources?	<input checked="" type="checkbox"/>	<input type="checkbox"/>
9. Will the proposed action result in an adverse change to natural resources (e.g., wetlands, waterbodies, groundwater, air quality, flora and fauna)?	<input checked="" type="checkbox"/>	<input type="checkbox"/>

	No, or small impact may occur	Moderate to large impact may occur
10. Will the proposed action result in an increase in the potential for erosion, flooding or drainage problems?	<input checked="" type="checkbox"/>	<input type="checkbox"/>
11. Will the proposed action create a hazard to environmental resources or human health?	<input checked="" type="checkbox"/>	<input type="checkbox"/>

**Part 3 - Determination of significance. The Lead Agency is responsible for the completion of Part 3.** For every question in Part 2 that was answered "moderate to large impact may occur", or if there is a need to explain why a particular element of the proposed action may or will not result in a significant adverse environmental impact, please complete Part 3. Part 3 should, in sufficient detail, identify the impact, including any measures or design elements that have been included by the project sponsor to avoid or reduce impacts. Part 3 should also explain how the lead agency determined that the impact may or will not be significant. Each potential impact should be assessed considering its setting, probability of occurring, duration, irreversibility, geographic scope and magnitude. Also consider the potential for short-term, long-term and cumulative impacts.

The new lot created by the proposed action will increase population density in the neighborhood if developed. However, this increase in density would be minor. There is small wetland area associated with a small intermittent stream and culvert under Triphammer Road along the northern parcel boundary. This wetland area is not mapped or regulated by any federal, state, or local agency, and the stream terminates into a storm water inlet on Klinewoods Road. The Planning Board recommends that conditions be placed on subdivision approval to minimize any negative environmental impact on the wetland and stream caused by development of the new lot. Therefore, based on the above, the environmental impacts associated with the proposed action are judged by the Planning Board to be small and the Board finds a negative determination of environmental significance.

<input type="checkbox"/>	Check this box if you have determined, based on the information and analysis above, and any supporting documentation, that the proposed action may result in one or more potentially large or significant adverse impacts and an environmental impact statement is required.
<input checked="" type="checkbox"/>	Check this box if you have determined, based on the information and analysis above, and any supporting documentation, that the proposed action will not result in any significant adverse environmental impacts.
Planning Board, Village of Cayuga Heights	<u>May 24, 2016</u>
Name of Lead Agency	Date
Frederick D. Cowett	Chair, Planning Board
Print or Type Name of Responsible Officer in Lead Agency	Title of Responsible Officer
<u>Frederick D. Cowett</u>	
Signature of Responsible Officer in Lead Agency	Signature of Preparer (if different from Responsible Officer)

**PRINT**